

MS800 SERIES

MASSUSE SWITCH

SPECIFICATIONS

CONTACT RATING: 6A with resistive load @ 120VAC or 28 VDC.

3A with resistive load @ 250 VAC

CONTACT RESISTANCE: 10MΩ max. initial.

ELECTRICAL LIFE: 30,000 actuations at full load.

INSULATION RESISTANCE: 1,000MΩmin.

DIELECTRIC STRENGTH : 1,000V RMS @ sea level.

OPERATING TEMPERATURE: -30°C to 85°C.

MATERIALS

CASE-Diallyl phthalate (DAP)

HOUSING – Stainless steel.

SLIDE HANDLE – Nylon.

CONTACTS – Coin silver, silver plated.

CENTER CONTACT & TERMINAL – Brass, silver plated.



Model NO.	TYPE		
DS-11	ON	NONE	ON
Term.	2-1	OPEN	2-3
Comm.	5-4		5-6

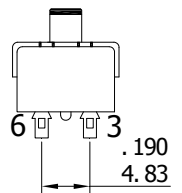
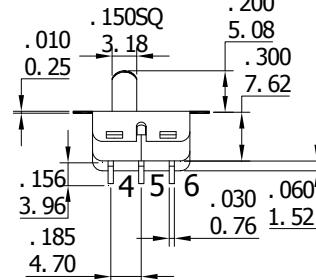
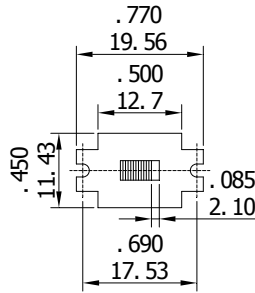

DPDT

Schematic

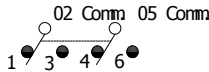

Model No.	TYPE		
DS-13	ON	NONE	ON
Term.	2-1	OPEN	2-3
Comm.			

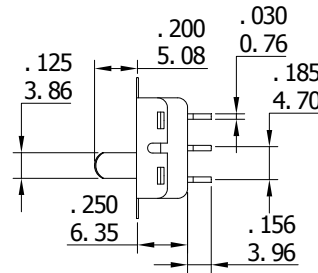
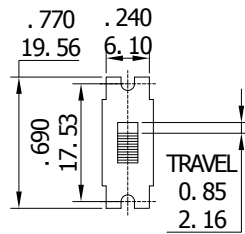

TERM NOS. FOR REFERENCE ONLY

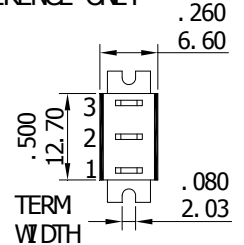

SPDT

Schematic

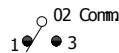

Model No.	Switching Position		
DS-13B	ON	NONE	OFF

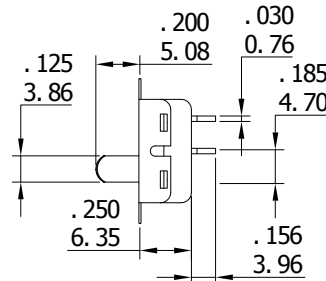
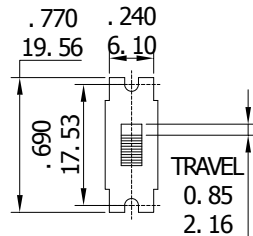

TERM NOS. FOR REFERENCE ONLY

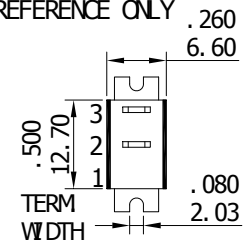

SPDT

Schematic



SPDT

Model No.	TYPE		
DS-13C	ON	NONE	ON
Term.	2-1	OPEN	2-3
Comm.			

Schematic

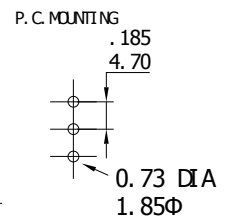
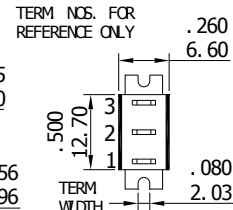
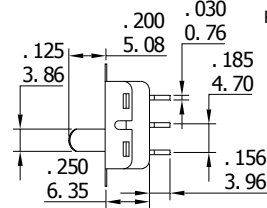
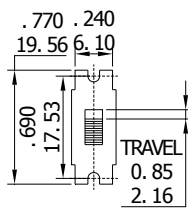

SPDT

Model No.	TYPE		
DS-13P	ON	NONE	ON
Term.	2-1	OPEN	2-3
Comm.			

Schematic

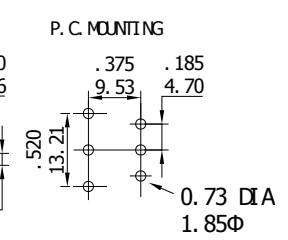
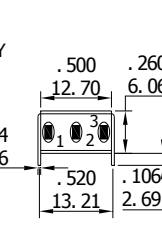
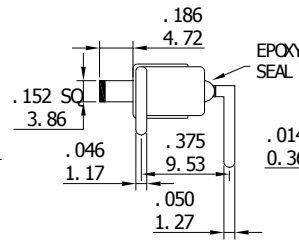
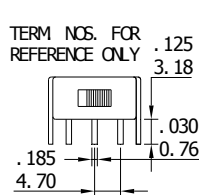

SPDT

Model No.	TYPE		
DS-13L	ON	NONE	ON
Term.	2-1	OPEN	2-3
Comm.			

Schematic

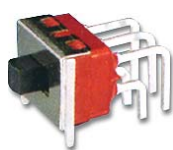
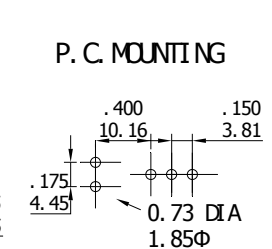
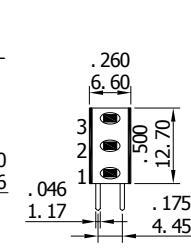
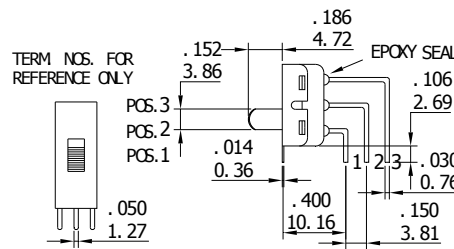

DPDT

Model No.	TYPE		
DS-11P	ON	NONE	ON
Term.	2-1	OPEN	2-3
Comm.	5-4		5-6

Schematic

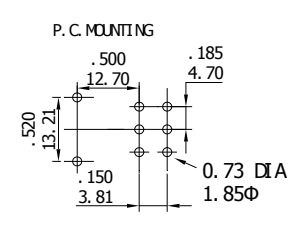
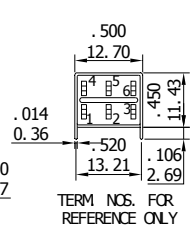
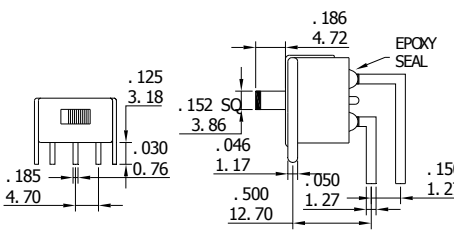

DPDT

Model No.	TYPE		
DS-11L	ON	NONE	ON
Term.	2-1	OPEN	2-3
Comm.	5-4		5-6

Schematic

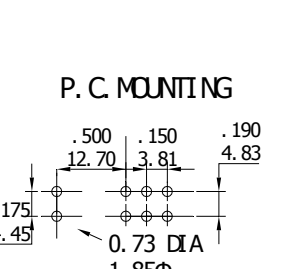
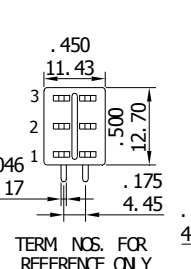
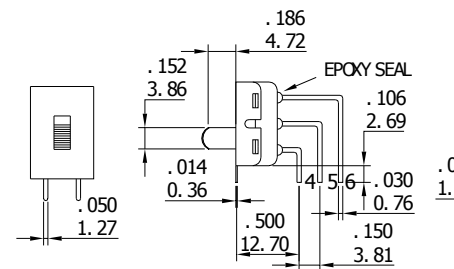

CONTACT MATERIAL OPTIONS

Q

End Terminal:

Contact Surface: coin silver

Center Terminal-

Contact Surface: Brass, Silver plated.

Body: Brass, silver plated.

Rating: 5 Amps with resistive load @ 120VAC or 28VDC

3 Amps with resistive load @ 250VAC

R

End Terminal-

Contact Surface: Brass with gold plate over nickel plate.

Center Terminal-

Contact Surface: Brass with gold plate over nickel plate

Body: Brass with gold plate over nickel plate

Rating: 0.4 Volt – Amps(VA)max. @ 20V max. (AC or DC)

TERMINATION OPTIONS

A1

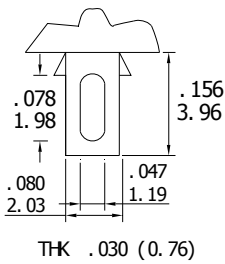

A2

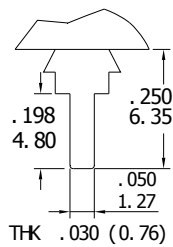

A3

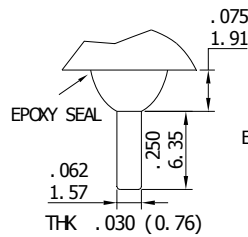

A4

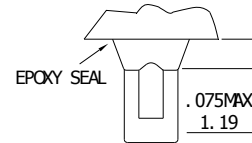

ACTUATOR OPTIONS

C1

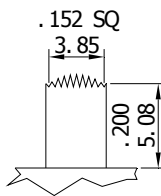

C2

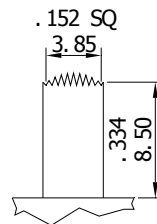

C3

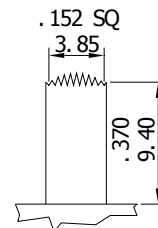

TERMINATIONS

