

# MS500 SERIES

# MASSUSE SWITCH

## SPECIFICATIONS

CONTACT RATING: 3A with resistive load @ 120VAC or 28 VDC.

ELECTRICAL LIFE: 30,000 make-and-break cycles at full load.

CONTACT RESISTANCE: 20MΩ max. initial @ 2.4VDC.100mA

For both coin silver and gold plated contacts.

INSULATION RESISTANCE: 1,000MΩmin.

DIELECTRIC STRENGTH : 1,000V RMS @ sea level.

OPERATING TEMPERATURE: -30°C to 85°C.

## MATERIALS

CASE- Diallyl phthalate (DAP)

ROCKER – Nylon.

BUSHING – Brass, nickel plated.

HOUSING – Stainless steel.

TERMINAL/SWITCH SUPPORT – Brass electrotin plated.

CONTACTS – Coin silver, silver plated.

CENTER CONTACT & TERMINAL – Brass, silver plated.



Model No.	Switching Position		
DS-41	ON	NONE	ON
DS-42	ON	OFF	ON
DS-43	ON	NONE	(ON)
Term.	2-3	OPEN	2-1
Comm..			

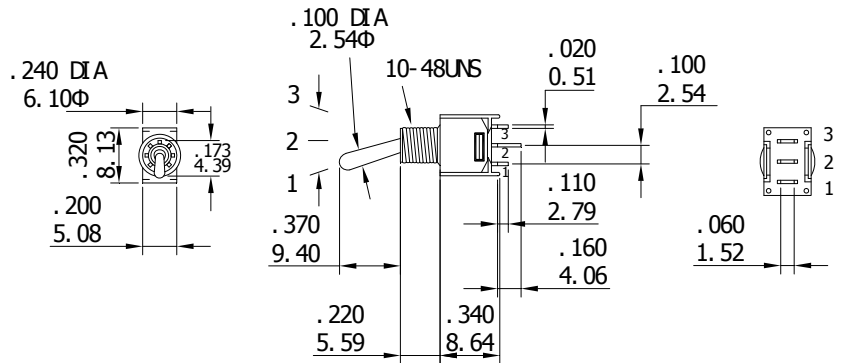

## SPDT

## Schematic

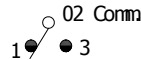

Model No.	Switching Position		
DS-51	ON	NONE	ON
DS-52	ON	OFF	ON
DS-53	ON	NONE	(ON)
Term.	2-3	OPEN	2-1
Comm..	5-6		5-4

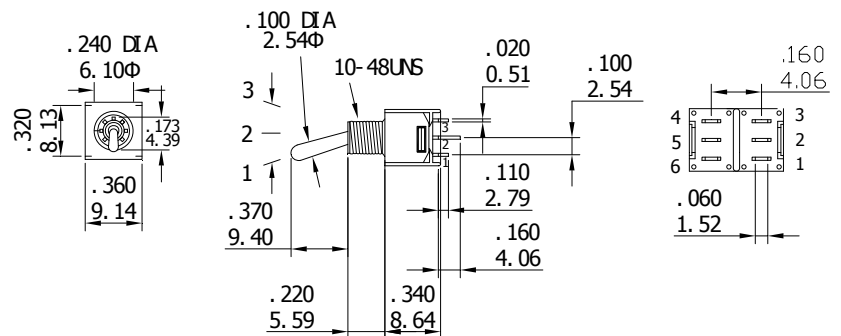

## DPDT

## Schematic

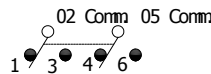

Model No.	Switching Position		
DS-61	ON	NONE	ON
DS-62	ON	OFF	ON
DS-63	ON	NONE	(ON)
Term.	2-3	OPEN	2-1
Comm..			

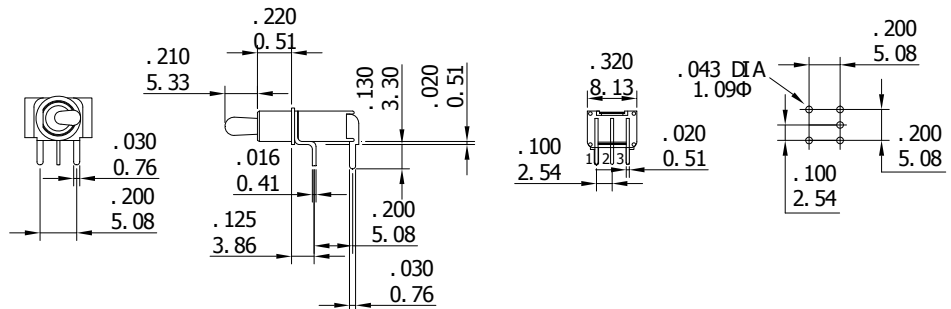

## SPDT

## Schematic

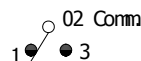



DPDT

Model No.	Switching Position		
	ON	NONE	ON
DS-71	ON	NONE	ON
DS-72	ON	OFF	ON
DS-73	ON	NONE	(ON)
Term.	2-3	OPEN	2-1
Comm..	5-6		5-4

Schematic

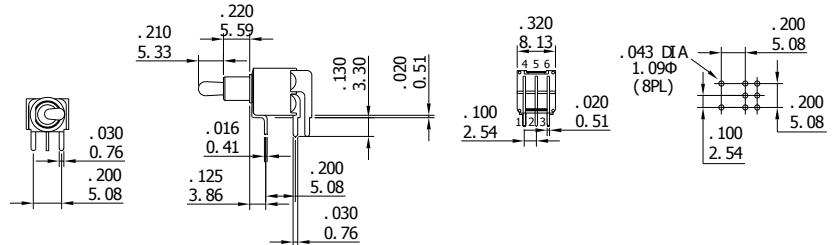
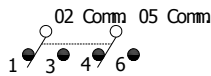

SPDT

Model No.	Switching Position		
	ON	NONE	ON
DS-81	ON	NONE	ON
DS-82	ON	OFF	ON
DS-83	ON	NONE	(ON)
Term.	2-3	OPEN	2-1
Comm..			

Schematic

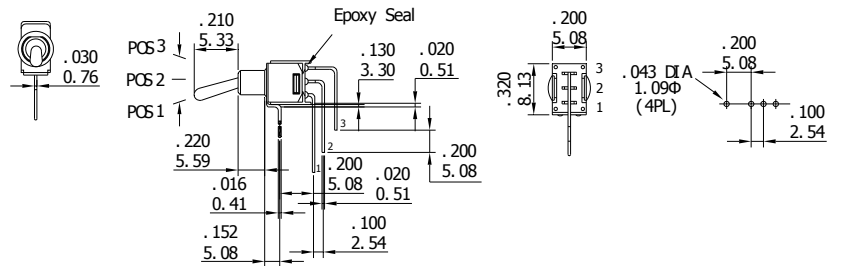
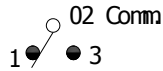

DPDT

Model No.	Switching Position		
	ON	NONE	ON
DS-91	ON	NONE	ON
DS-92	ON	OFF	ON
DS-93	ON	NONE	(ON)
Term.	2-3	OPEN	2-1
Comm..	5-6		5-4

Schematic

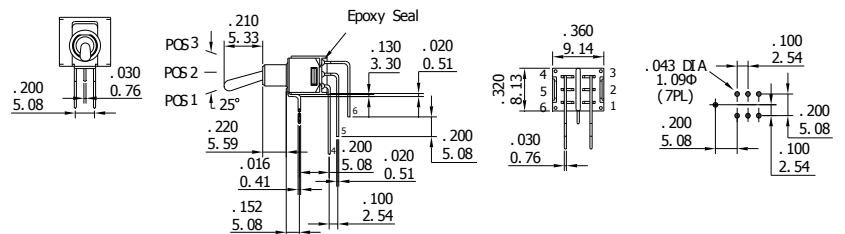
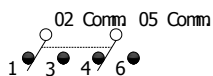

VERTICAL SUPPORT BRACKET OPTIONS

DS-10



P.C. MOUNTING

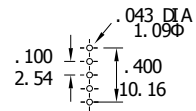
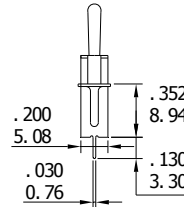
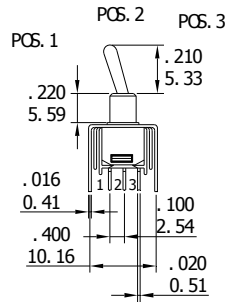

SPDT

DS-20

P.C. MOUNTING

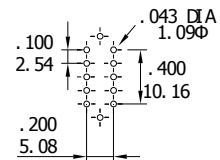
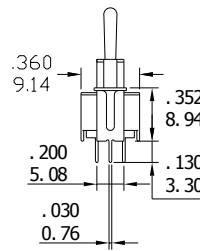
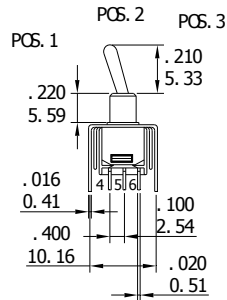

DPDT

ACTUATOR OPTIONS

T1 SID

T2

T3

T4

T5

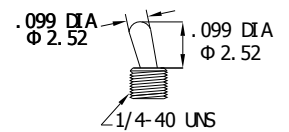
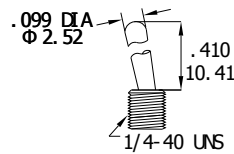
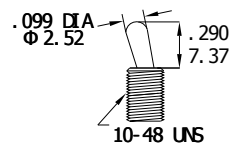
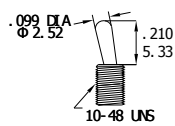
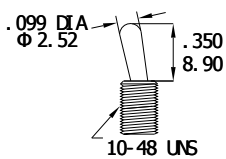

BUSHING OPTIONS

B1 THD  
B2 NON-THD

B3 THD  
B4 NON-THD

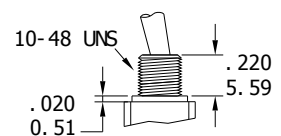
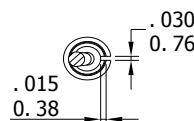
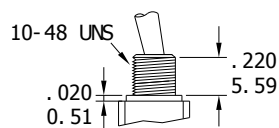

B5 THD  
B6 NON-THD

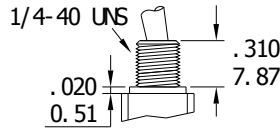
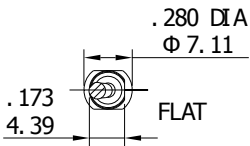

B7 THD  
B8 NON-THD

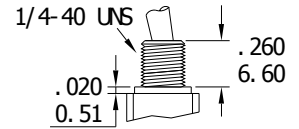
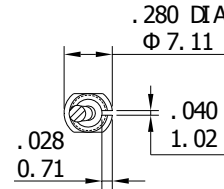

## TERMINATION OPTIONS

A1

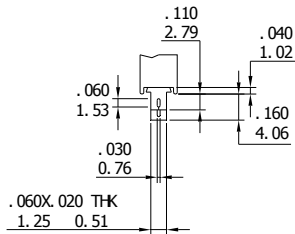

A2

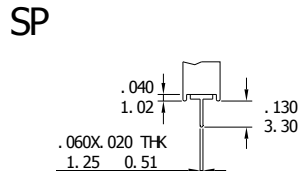

A3

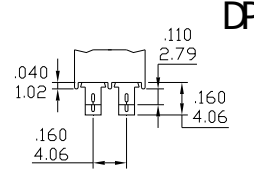

A4

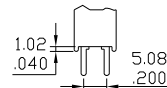

## CONTACT MATERILA OPTIONS

Q

END CONTACTS: Coin silver, silver plated.  
CENTER CONTACT & ALL TERMINALS: Brass, silver plated.  
RATING: 3 AMPS @ VAC or 28 VDC; 1 AMPS @ 250 VAC.

R

CONTACTS & TERMINALS: Brass, with gold plate  
Over nickel plate.  
RATING: 0.4 VA max. @ 20 VAC or DC max.