

FEATURES

- DIP industry standard package
- Transfer molded for environmental protection
- Miniature size
- Compatible with DIP handling ,sorting and PCB insertion equipment
- Optional shielding and diodes

CONTACT DATA

Parameters		MED2A	MED1C
Power (W)Max.		10	3
Voltage (VDC) max.		200	100
Switching Current (A) max.		0.5	0.25
Carry Current (A) max.		1	0.5
Contact Resistance (Ω) max.(initial)		0.15	0.15
Breakdown Voltage(VDC)min.	Open Contact	250	200
	Contact to Coil	-	-
Insulation Resistance(Ω)min	Open Contact	10^{10}	10^8
	Contact to Coil	10^{10}	10^{10}
Operate Time (mS) max.(incl. Bounce)		1	2
Release Time (mS) max.		0.5	2.5
Electrical Life	Low Level	$10^8(10\text{mVDC}, 10\mu\text{A})$	$5 \times 10^8(10\text{VDC}, 4\text{mA})$
	Rated Load	$6 \times 10^5(20\text{VDC}, 0.5\text{A})$	$2 \times 10^6(12\text{VDC}, 0.25\text{A})$

COILSPECIFICATIONS

Part Number	Nominal Voltage (VDC)	Coil Resistance ($\Omega \pm 10\%$)	Operate Voltage (VDC)max.	Release Voltage (VDC)min.
MED2A	5	200	3.8	0.5
	12	500	9	1
	24	1750	18	2
MED1C	5	200	3.8	0.5
	12	500	9	1
	24	1750	18	2

ORDERING INFORMATION

<u>MED</u>	<u>1A</u>	-	<u>05</u>	<u>B</u>	<u>W</u>	<u>D</u>
Model No.	Contact Form	Coil Voltage	Power	Magnetic shield	Diode	
MED	1A, 2A, 1C	5VDC, 12VDC, 24VDC	B:10W C:3W	W:Standard X:Magnetic shield	Nil: Without diode D: With diode	

Dimensions (unit:mm)

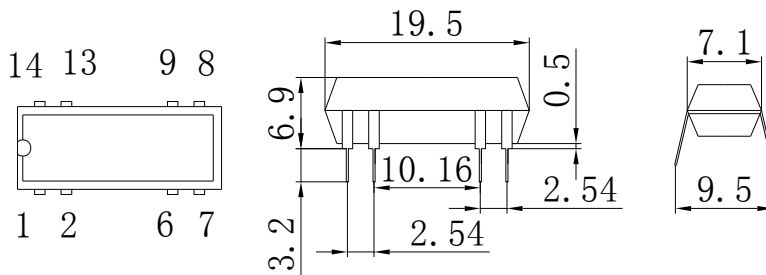

SCHEMATICS

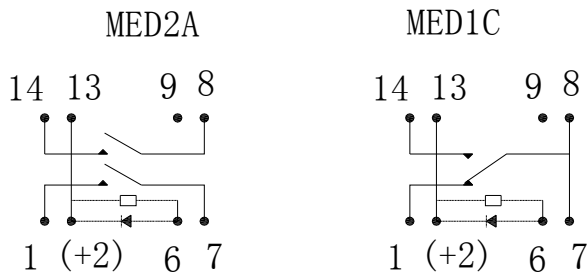

Disclaimer: All the specifications are subject to change without notice.