

Features

- Offers excellent board space savings
- Surge withstand voltage up to 2500V, meets FCC Part 68 and Telecordia
- Meets EN60950/EN41003
- High contact capacity 2A 30VDC
- Low power consumption
- Single side stable and latching type available
- Environmental friendly product (RoHS compliant)
- UL and CUL approval NO.: E179936

CONTACTS DATA

Contact arrangement	2 C	
Initial contact resistance (Initial)	70 mΩ	
Contact material	Silver alloy, Gold clad	
Contact rating (resistance)	2 A, 30 VDC 0.5 A, 125 VAC	
Max. switching power	60 W, 62.5 VA	
Max. switching voltage	220VDC, 250VAC.	
Max. switching current	2 A	
Min. applicable load	10μA 10mVDC	
Mechanical life	1×10 ⁸	
Electrical life	1×10 ⁵ (at 0.5 A, 125 VAC) 1×10 ⁵ (at 2 A,30 VDC)	
COIL		
Power Consumption	Single side stable	140mW
	1 coil latching	100mW
Temperature rise	50K max	
Coil voltage	See coil data table	

CHARACTERISTICS

Insulation resistance	1000 MΩ (at 500VDC)
Dielectric strength	1600VAC 1 min 1000VAC 1 min 1800VAC 1 min
Surge withstand voltage	1500V (FCC part 68) 2500V (Telecordia)
Operate time (Set time)	Max. 3ms
Release time (Reset time)	Max. 3ms
Ambient temperature	-40°C to +85 °C
Humidity	98% R.H., 40°C
Vibration resistance	DA:3.3mm, 10 to 55Hz DA:5.0mm, 10 to 55Hz
Shock resistance	735 m/s ² (75g) 980 m/s ² (100g)
Construction	Wash tight
Terminal	DIP
Weight	Approx. 0.8g

COIL DATA TABLE

Single side stable

at 23°C

Order Number	Nominal Voltage VDC	Pick-up Voltage VDC (Max)	Drop-out Voltage VDC (Min)	Coil Resistance Ω $\pm 10\%$	Power Consumption mW	Max. Allow Voltage VDC
ME-60-1.5	1.5	1.13	0.15	16	140	2.2
ME-60-3	3	2.25	0.3	64.3	140	4.5
ME-60-4.5	4.5	3.38	0.45	145	140	6.7
ME-60-5	5	3.75	0.5	178	140	7.5
ME-60-6	6	4.5	0.6	257	140	9.0
ME-60-9	9	6.75	0.9	579	140	13.5
ME-60-12	12	9	1.2	1028	140	18.0
ME-60-24	24	18	2.4	2880	200	36.0

1 coil latching

at 23°C

Order Number	Nominal Voltage VDC	Set Voltage VDC (Max)	Reset Voltage VDC (Max)	Coil Resistance Ω 10%	Power Consumption mW	Max. Allow Voltage VDC
ME-60-L1-1.5	1.5	1.13	1.13	22.5	100	3.0
ME-60-L1-3	3	2.25	2.25	90	100	6.0
ME-60-L1-4.5	4.5	3.38	3.38	203	100	9.0
ME-60-L1-5	5	3.75	3.75	250	100	10.0
ME-60-L1-6	6	4.5	4.5	360	100	12.0
ME-60-L1-9	9	6.75	6.75	810	100	18.0
ME-60-L1-12	12	9	9	1440	100	24.0
ME-60-L1-24	24	18	18	2880	200	36.0

Note: When user's requirements can't be found in the above table, counsel with MASSUSE ELECTRIC LTD.

ORDERING INFORMATION

Model No	Operating function	Coil voltage	Terminal Type	Packing Style	Special code
ME-60	Nil: single side stable L1: 1 coil latching	1.5VDC,3VDC,4.5VDC 5VDC, 6VDC, 9VDC 12VDC, 24VDC	Nil: DIP S: Standard SMT S1: Short terminal SMT	Nil: Tube packing R: Tape and reel packing (only for SMT type)	Special code

Dimensions (Unit: mm)

Tolerance: ± 0.2

DIP type

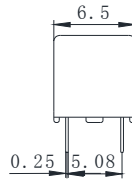
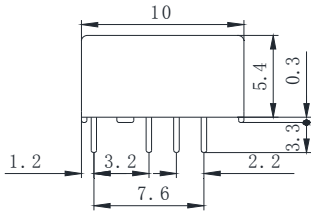

PCB Layout

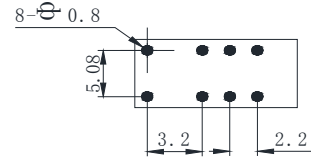

Standard SMT type

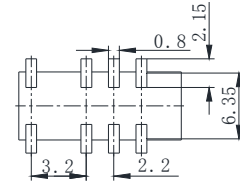
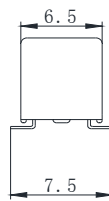
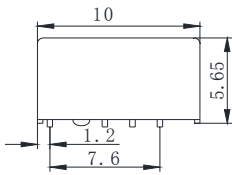

Short terminal SMT type

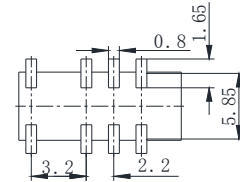
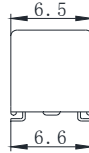
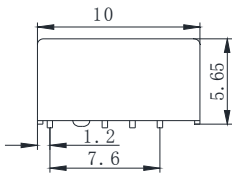

Single side stable

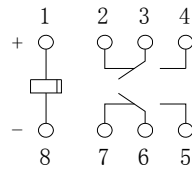

1 coil (Latching type)

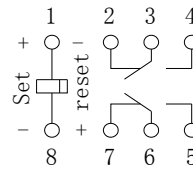

Terminal assignment (bottom view)

Disclaimer: All the specifications are subject to change without notice.