

FEATURES

- Breakdown voltage between contacts and coil: 3000V and 2000V
- Surge withstand between contacts and coil: 2500V
- High contact capacity: 2A / 30VDC
- UL and CUL approval, File No. E179936

CONTACT DATA

Contact form	2C
Max. contact resistance (Initial)	100mΩ(10mA 30mVDC)
Contact rating (resistive)	2A/30VDC, 0.5A125VAC
Max. switching current	2A
Max. switching power	62.5VA/60W
Max. switching voltage	220VDC/250VAC
Min. applicable load	10mV 10μA
Contact material	Silver alloy / Gold clad

CHARACTERISTICS

Insulation resistance	Min. 1000MΩ min (at 500VDC)
Dielectric strength - Between coil and contacts - Between open contacts - Between contact sets	ME-5: 2000VAC (1 min.) ME-5-W: 3000VAC (1 min.) ME-5:1000VAC (1 min.) ME-5-W:1500VAC(1 min.) 1500VAC (1 min.)
Surge withstand voltage - Between coil and contacts - Between open contacts(10/160μs)	ME-5: 2500V(Telecordia,2/10μs) ME-5-W: 6000V (1.2/50μs) ME-5: 1500VAC (FCC part 68) ME-5-W: 2500V
Operate time (set & reset time)	ME-5: Max. 4 ms ME-5-W: Max. 6 ms
Release time	ME-5: Max. 4 ms ME-5-W: Max. 6 ms
Vibration resistance	Functional: 10 – 55Hz DA 3.3mm Destructive: 10 – 55Hz DA 5mm
Shock resistance	Functional: 735m/s ² Survival: 980m/s ²
Relative humidity	5% - 85% RH
Ambient temperature	-40°C to +85°C
Life expectancy - Electrical(ME-5) (ME-5-W) - Mechanical (ME-5) (ME-5-W)	1x10 ⁵ OPS(0.5A/125VAC,Resistive load, AgNi+Au plated, at 85°C,1s on 9s off) 1x10 ⁵ OPS(0.5A/125VAC,Resistive load,at 85°C,1s on 9s off) 1 x 10 ⁸ operations 1 x 10 ⁷ operations

COIL SPECIFICATIONS - 1. Single side stable

Nominal voltage (VDC)		Coil voltage VDC(Max.)		Pick-up voltage VDC(Max.)		Drop-out voltage VDC(Min.)		Coil resistance ($\Omega \pm 10\%$)		Power consumption (W)	
ME-5	ME-5-W	ME-5	ME-5-W	ME-5	ME-5-W	ME-5	ME-5-W	ME-5	ME-5-W	ME-5	ME-5-W
1.5		2.2		1.13		0.15		16	11.2	0.14	0.2
2.4		3.6		1.8		0.24		41.1	28.8	0.14	0.2
3		4.5		2.25		0.3		64.3	45	0.14	0.2
4.5		6.7		3.38		0.45		145	101	0.14	0.2
5		7.5		3.75		0.5		178	125	0.14	0.2
6		9		4.5		0.6		257	180	0.14	0.2
9		13.5		6.75		0.9		579	405	0.14	0.2
12		18		9		1.2		1028	720	0.14	0.2
24		36		18		2.4		4114	2880	0.14	0.2
48	---	57.6	---	36	---	4.8	---	8533	---	0.27	---

2. 1 Coil Latching

Nominal voltage (VDC)		Coil voltage VDC (Max.)		Set/Reset voltage VDC(Max.)		Coil resistance ($\Omega \pm 10\%$)		Power consumption(W)	
ME-5	ME-5-W	ME-5	ME-5-W	ME-5	ME-5-W	ME-5	ME-5-W	ME-5	ME-5-W
1.5		2.7		1.13		22.5	16.1	0.1	0.14
2.4		4.3		1.8		58	41	0.1	0.14
3		5.4		2.25		90	64.3	0.1	0.14
4.5		8.1		3.38		203	145	0.1	0.14
5		9		3.75		250	178	0.1	0.14
6		10.8		4.5		360	257	0.1	0.14
9		16.2		6.75		810	579	0.1	0.14
12		21.6		9		1440	1028	0.1	0.14
24		43.2		18		5760	4114	0.1	0.14

3. 2 Coil Latching

Nominal voltage (VDC)	Coil voltage VDC (Max.)	Set/Reset voltage VDC(Max.)	Coil resistance ($\Omega \pm 10\%$)	Power consumption(W)
1.5	2.2	1.13	11.2	0.2
2.4	3.6	1.8	29	0.2
3	4.5	2.25	45	0.2
4.5	6.7	3.38	101	0.2
5	7.5	3.75	125	0.2
6	9	4.5	180	0.2
9	13.5	6.75	405	0.2
12	18	9	720	0.2
24	36	18	2880	0.2

ORDERING INFORMATION

<u>ME-5</u>	- <u>L1</u>	- <u>12</u>	<u>S</u>	<u>R</u>	<u>W</u>
Model No.	Sort	Coil Voltage	Terminal type	Packing style	Dielectric voltage between coil & contacts
ME-5	Nil: Single side stable L1: 1 coil latch L2: 2 coil latch	1.5、2.4、3、 4.5、5、6、9、 12、24 and 48VDC	Nil: DIP S : Standard SMT S1 : Space saving SMT	R: Tape and reel packing (only for SMT type) Nil: Tube packing	Nil: Standard W: 3000VAC

NOTE: ME-5-W is suitable for single side stable & 1coil latch only.

Dimensions(unit:mm)

Tolerance:±0.3

1. Single side stable and 1 coil latching

Outline Dimensions
(DIP type)

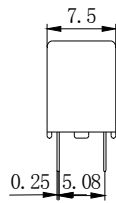
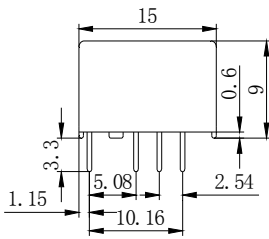

PCB Layout (DIP type) (Bottom view)

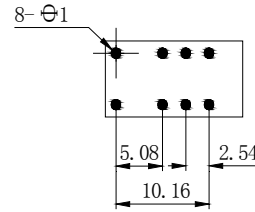

Out line Dimensions (Standard SMT type)

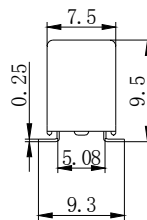
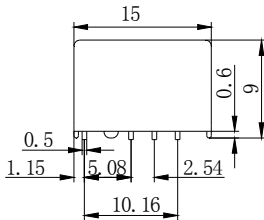

PCB Layout (Standard SMT type) (Bottom view)

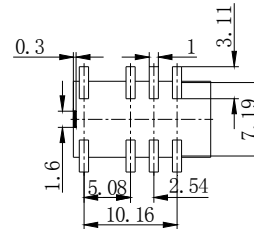

Out line Dimensions (Space saving SMT type)

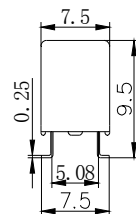
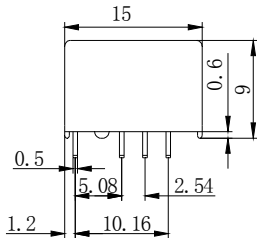

PCB Layout (Space saving SMT type) (Bottom view)

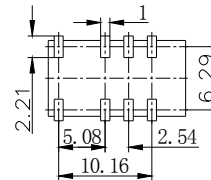

wiring Diagram (Bottom view)

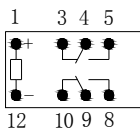

single side stable
No energized condition

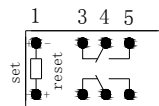

1 coil latching
reset condition

Tolerance:±0.3

2. Coil latching
Outline Dimensions (DIP type)

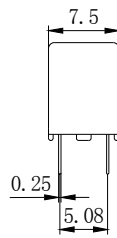
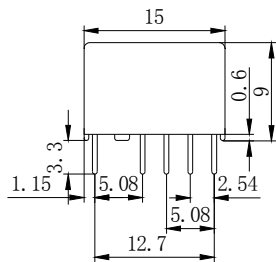

PCB Layout (DIP type) (Bottom view)

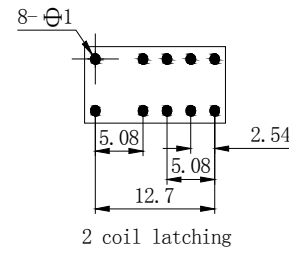

Out line Dimensions (Standard SMT type)

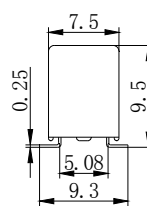
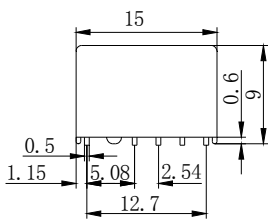

PCB Layout(Standard SMT type) (Bottom view)

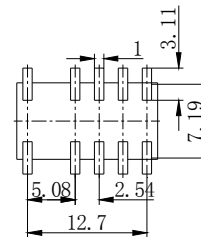

Out line Dimensions(Space saving SMT type)

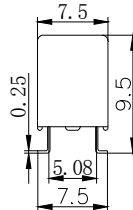
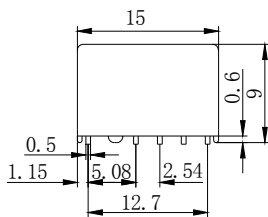

PCB Layout(Space saving SMT type) (Bottom view)

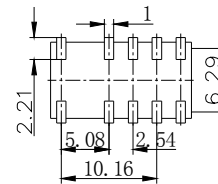

wiring Diagram(Bottom view)

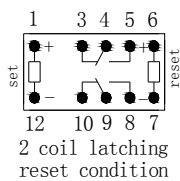

Disclaimer: All the specifications are subject to change without notice.