

## FEATURES

- 10A, 8A, 5A, 3A switching capabilities
- 1A-NO and 1C configurations
- Subminiature, standard PC layout
- Thermal class B for high temperature
- UL & CUL approval, File No. E179936
- VDE approval, File No.40025865

## CONTACT DATA

Contact form	1A – NO ; 1C
Contact resistance (Initial)	Max. 100mΩ
Contact rating 1A(NO) -standard	5A/250VAC 5A/30VDC 10A/125VAC
1A(NO) -sensitive	3A/250VAC 3A/30VDC 5A/125VAC
LQ	8A/250VAC
Q	10A/250VAC
1C(NO/NC)	3A/250VAC 3A/30VDC 5A/125VAC
Inductive load	2A 250VAC CosΦ=0.5
Max.switching current	10A
Contact material	Silver Alloy

## CHARACTERISTICS

Insulation resistance	100MΩ at 500VDC
Dielectric strength	2500VAC, between coil to contacts (1 minute) 1000VAC, between open contacts (1 minute)
Operate time	≅ 8 ms
Release time	≅ 5 ms
Shock	Malfunction: 98m/s <sup>2</sup> Mechanical: 980m/s <sup>2</sup>
Vibration	10-55Hz, 1.5mm
Humidity	35% to 95%RH
Ambient temperature	- 40°C to 85°C
Life expectancy	
- Electrical	1 x 10 <sup>5</sup> operations (at rated load)
- Mechanical	1 x 10 <sup>6</sup> operations (no load)

## COIL SPECIFICATIONS – 1. Standard

Nominal voltage (VDC)	Pick-up voltage VDC(Max.)	Drop-out voltage VDC (Min.)	Nominal current (mA±10%)	Coil resistance (Ω±10%)	Power consumption(mW)
3	2.25	0.15	150	20	450
5	3.75	0.25	90	55	450
6	4.5	0.3	75	80	450
9	6.75	0.45	50	180	450
12	9	0.6	37.5	320	450
18	13.5	0.9	25	720	450
24	18	1.2	18.8	1280	450
48	36	2.4	9.4	5120	450

## 2. Sensitive for 1A

Nominal voltage (VDC)	Pick-up voltage VDC (Max.)	Drop-out voltage VDC (Min.)	Nominal current (mA±10%)	Coil resistance (Ω±10%)	Power consumption(mW)
3L	2.25	0.15	66.7	45	200
5L	3.75	0.25	40	125	200
6L	4.5	0.3	33.3	180	200
9L	6.75	0.45	22.2	400	200
12L	9	0.6	16.7	720	200
18L	13.5	0.9	11.1	1600	200
24L	18	1.2	8.3	2800	200

## ORDERING INFORMATION

ME-10 - 012 - H S L Q 3 G 2

Model No.	Coil Voltage	Contact Form	Protection	Power Consumption	Contact Rating	Contact Material	Cladding Material	Terminals
ME-10	3, 5, 6, 9, 12 18, 24 or 48VDC	H: 1A Z: 1C	Nil: Flux free type S: Sealed type	Nil: Standard L: High sensitive	Nil: Standard Type LQ: 8A 250VAC Q:10A 250VAC	Nil: AgSnO 3: AgNi	Nil: None G: Gold plated	2: Type 2 Terminals

\* NOTE: Sensitive type is suitable for 1A only. \*

Dimensions (unit: mm) Tolerance:±0.3

Type 2

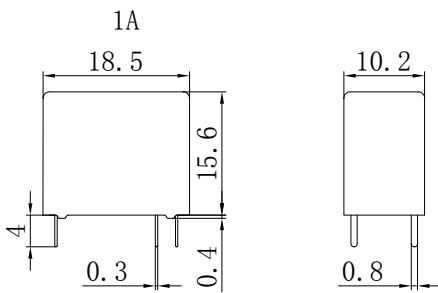

Schematic

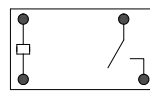

PCB Layout

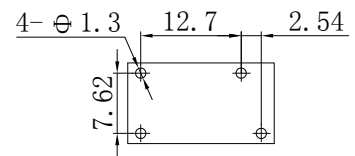

1C

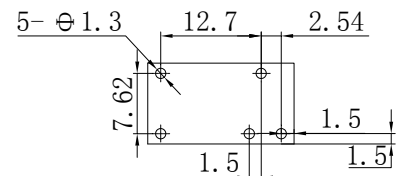
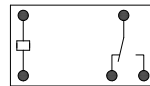
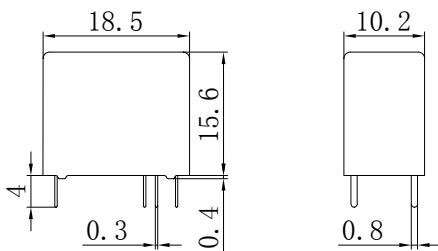

Disclaimer: All the specifications are subject to change without notice.