

FEATURES

- Low coil power consumption
- Operation noise: less than 50db
- Small size (22.5mm x 16.5mm x 16.5mm)
- PCB broad mounting

CONTACT DATA

| | |
|---------------------------------|--------------------------------|
| Contact form | 2x1C |
| Contact resistance (Initial) | $\leq 50\text{m}\Omega$ |
| Contact rating (Resistive) | NO: 20A/14VDC NC: 10A/14VDC |
| Max. switching power | 300W |
| Max. switching voltage | 16VDC |
| Max. switching current | 20A |
| Contact material | AgSnO ₂ |

CHARACTERISTICS

| | |
|-----------------------|---------------------------------------|
| Insulation resistance | 100M Ω min (at 500VDC) |
| Dielectric strength | 50Hz 1000V, between coil and contacts |
| | 50Hz 1000V, between contacts |
| Operate time | ≤ 10 ms |
| Release time | ≤ 10 ms |
| Vibration resistance | 10-100Hz 45m/s ² |
| Shock resistance | Function 100m/s ² 11ms |
| | Survival 1000m/s ² 6ms |
| Humidity | 85% (at 40°C) |
| Ambient temperature | - 40°C to +85°C |
| Life expectancy | |
| - Electrical | 10 ⁵ |
| - Mechanical | 10 ⁷ |

COIL SPECIFICATIONS

| Nominal voltage (VDC) | Operating voltage range (VDC) | Pick-up voltage VDC(Max.) | Drop-out voltage VDC(Min.) | Nominal current (mA \pm 10%) | Coil resistance (Ω \pm 10%) | Power consumption (W) |
|--------------------------|-------------------------------------|------------------------------|-------------------------------|-----------------------------------|--|-----------------------------|
| 12 | 10 - 16 | 7.2 | 1 | 53.3 | 225 | 0.64 |

ORDERING INFORMATION

| | | | | |
|------------|---|------------|----------|----------|
| <u>MC3</u> | - | <u>012</u> | <u>Q</u> | <u>2</u> |
| | | | | |

| Model No. | Coil Voltage | Noise | Contact Form |
|-----------|--------------|---------------------------|--------------|
| MC3 | 12VDC | Nil: standard Q: Quiet | 2: 2 xC |

Dimensions(unit:mm)

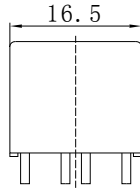
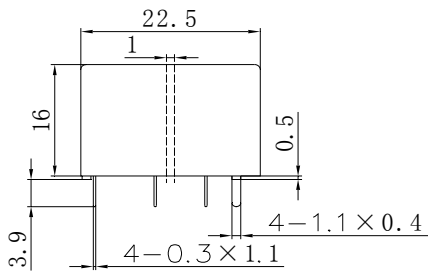

PCB Layout

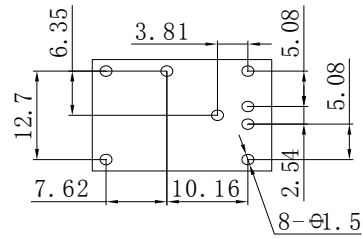

Schematic

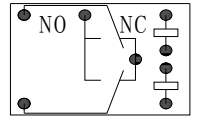

Disclaimer: All the specifications are subject to change without notice.