

M100 SERIES

MASSUSE SWITCH

SPECIFICATIONS

CONTACT RATING: 5A with resistive load @ 120VAC or 28 VDC.

ELECTRICAL LIFE: 50,000 make-and-break cycles at full load.

CONTACT RESISTANCE: 10MΩ max. initial @ 2.4VDC.100mA

For both coin silver and gold plated contacts.

INSULATION RESISTANCE: 1,000MΩmin.

DIELECTRIC STRENGTH : 1,000V RMS @ sea level.

OPERATING TEMPERATURE: -30°C to 85°C.

plated.

MATERIALS

CASE-melamine or diallyl phthalate (DAP)

TOGGLE HANDLE - Brass, chrome plated.

BUSHING – Brass, nickel plated.

HOUSING – Stainless steel.

END CONTACT Coin silver, silver plated.

END TERMINAL Brass, silver plated.

CENTER CONTACT & TERMINAL – Brass, silver plated.



SPDT

Model No.	Switching Position		
T101	ON	NONE	ON
T102	ON	NONE	(ON)
T103	ON	OFF	ON
T104	(ON)	OFF	(ON)
T105	ON	OFF	(ON)
Term.	2-3	OPEN	2-1
Comm..			

Schematic

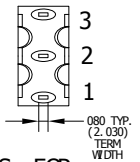
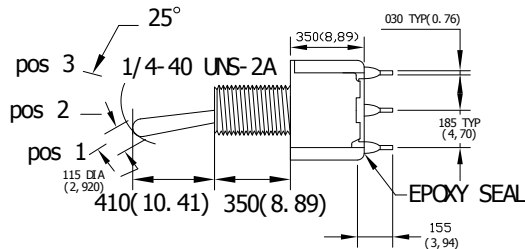
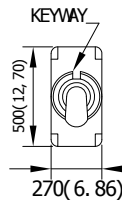
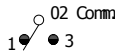

TERM NOS. FOR REFERENCE ONLY



DPDT

Model No.	Switching Position		
T201	ON	NONE	ON
T202	ON	NONE	(ON)
T203	ON	OFF	ON
T204	(ON)	OFF	(ON)
T205	ON	OFF	(ON)
Term.	2-3	OPEN	2-1
Comm..	5-6		5-4

Schematic

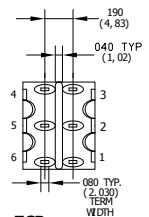
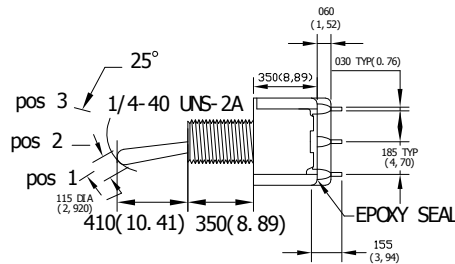
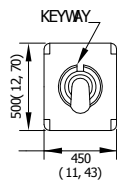
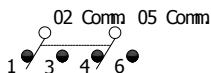

TERM NOS. FOR REFERENCE ONLY

M100 SERIES

MASSUSE SWITCH



3PDT

Model No.	Switching Position		
	ON	NONE	ON
T301	ON	NONE	ON
T302	ON	NONE	(ON)
T303	ON	OFF	ON
T304	(ON)	OFF	(ON)
T305	ON	OFF	(ON)
Term.	2-3	OPEN	2-1
Comm..	5-6,8-9		5-4,8-7

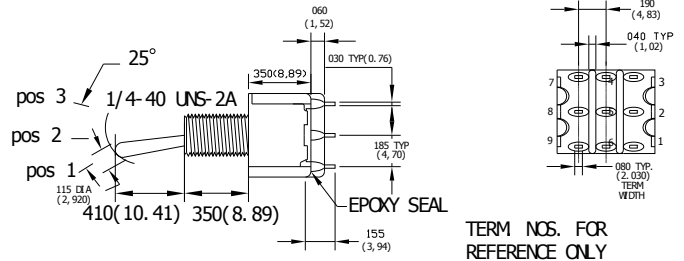
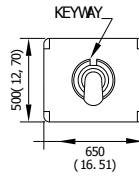

TERM NOS. FOR REFERENCE ONLY

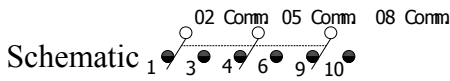

4PDT

Model No.	Switching Position		
	ON	NONE	ON
T401	ON	NONE	ON
T402	ON	NONE	(ON)
T403	ON	OFF	ON
T404	(ON)	OFF	(ON)
T405	ON	OFF	(ON)
Term.	2-3,5-6	OPEN	2-1,5-4
Comm..	8-9,11-12		8-7,11-10

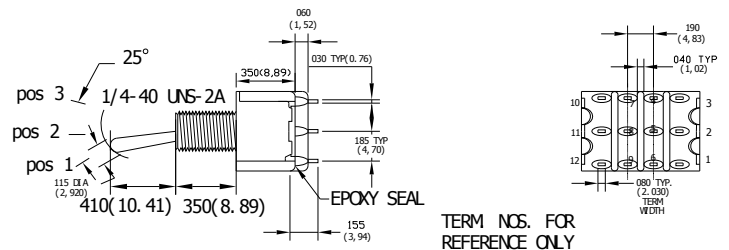
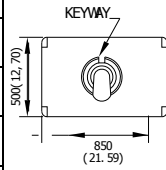

TERM NOS. FOR REFERENCE ONLY

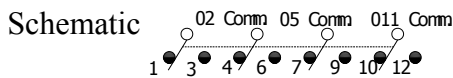

T-10

SPDT

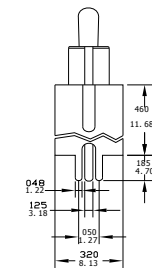
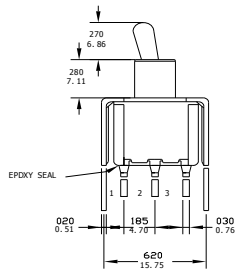

P. C. MOUNTING

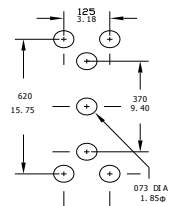

T-20

DPDT

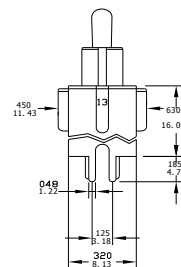
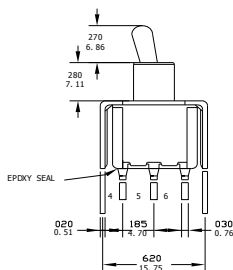

P. C. MOUNTING

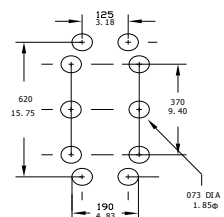

T1

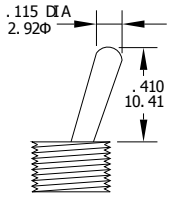

T2

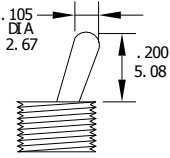

T3

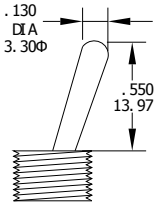

T4

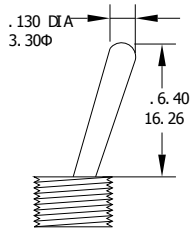

T5

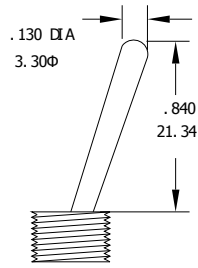

T6

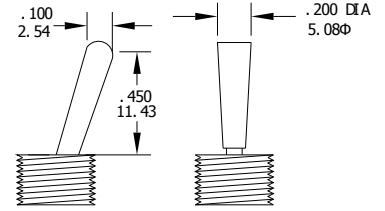

B2 NON-THD

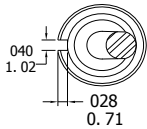

B4 NON-THD

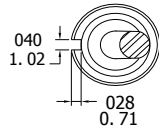

B5 HIGH TORQUE

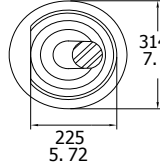

B6 HIGH TORQUE

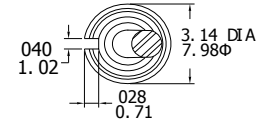

B1 THD STD

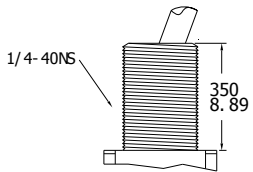

B3 THD

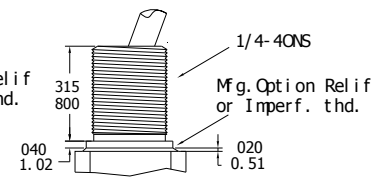
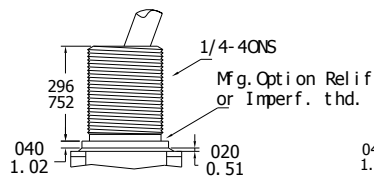
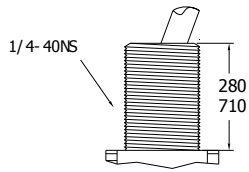

B7 LONG

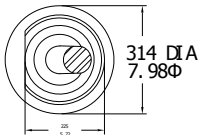

B8 METRIC

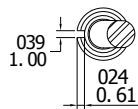

RUBBER HOOD

SEALING

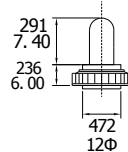

B9 SPLASH-PROOF

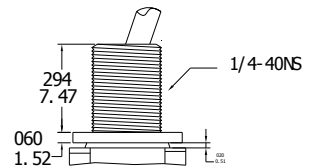
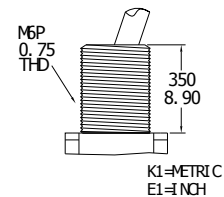
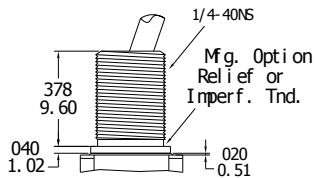
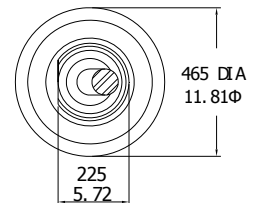

TERMINATION OPTIONS

A1 STD

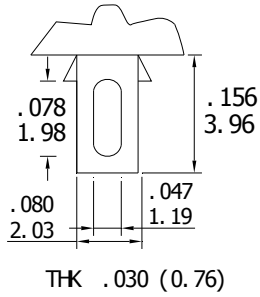

A2

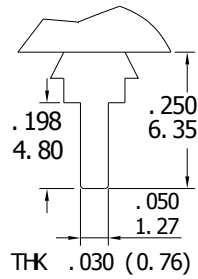

A3-E

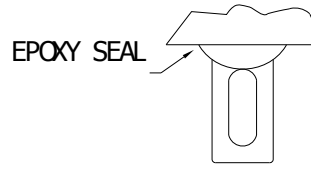

A4-E

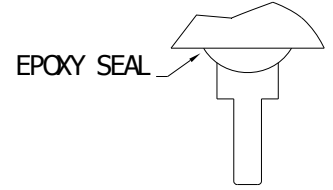

PANEL MOUNTING

1/4 IN. BUSHING

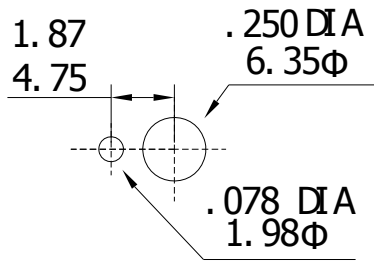
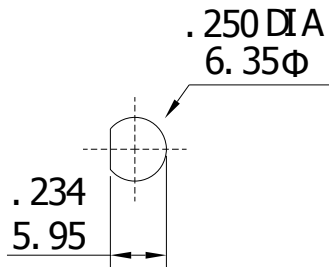
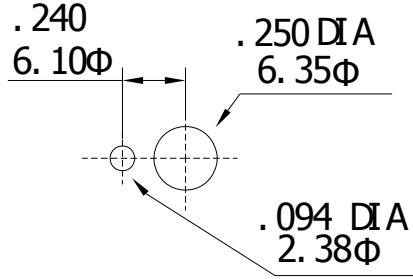
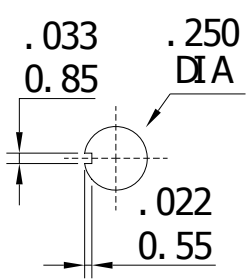

METRIC BUSHING

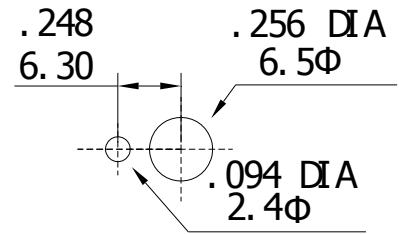
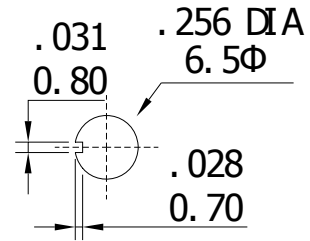

UNT

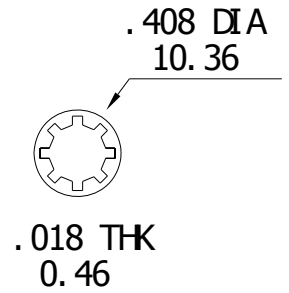
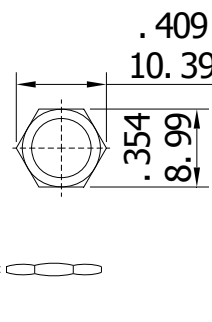
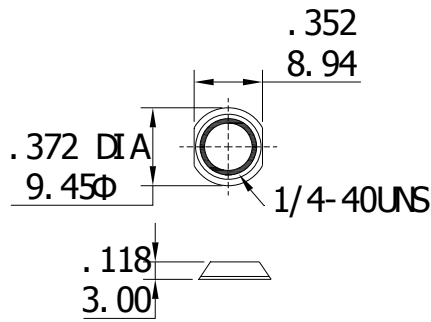
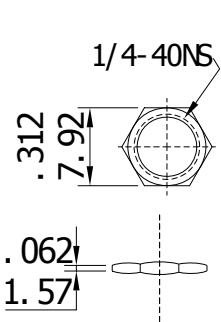

LOCKING RING

TOGGLE CAPS

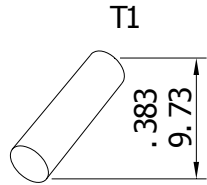
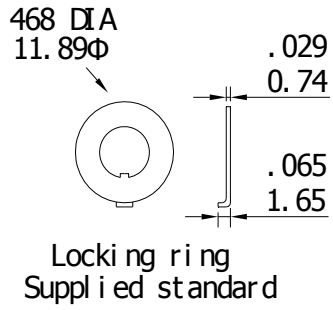

Material
Vinyl
for Option "S"

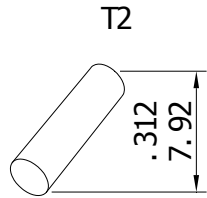
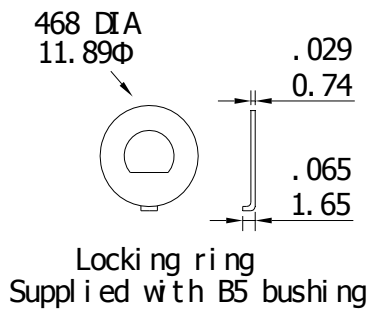

Material
Polyethylene
for Option "S"